

INTERNATIONAL PROJECTS



Battle Creek, Battlefield Memorial, Ontario.



Bartletts Ferry Dam, Georgia, USA.



Madison Ave, New York, USA.

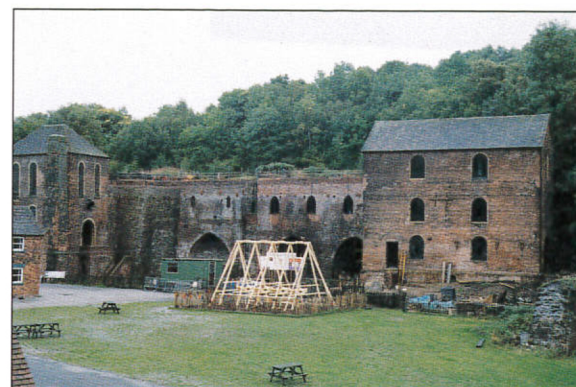

Blists Hill Blast Furnaces, U.K.



Arundel Castle, U.K.

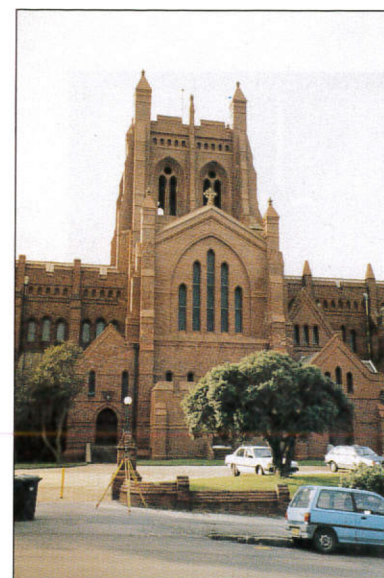

Christ Church Cathedral, Newcastle, Australia.

SPINETEC

The connection of anchors within structures.

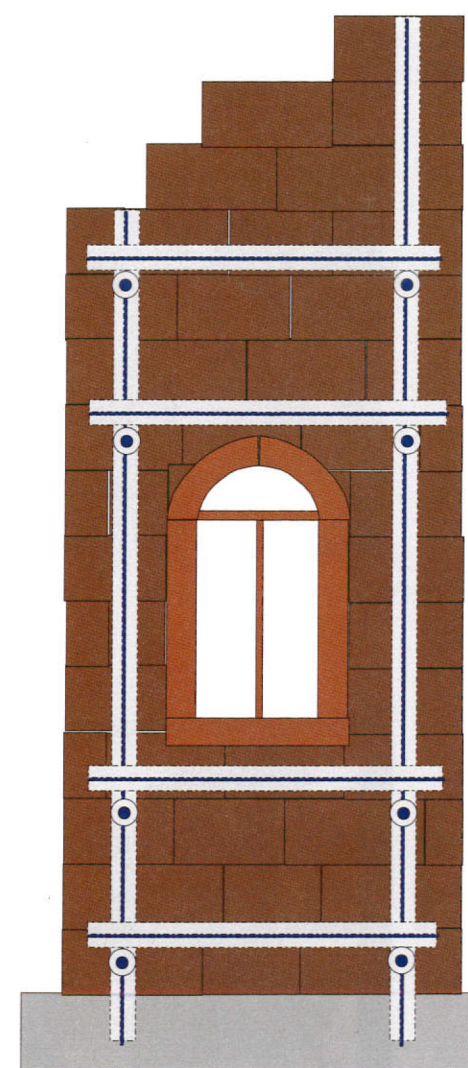

elevation

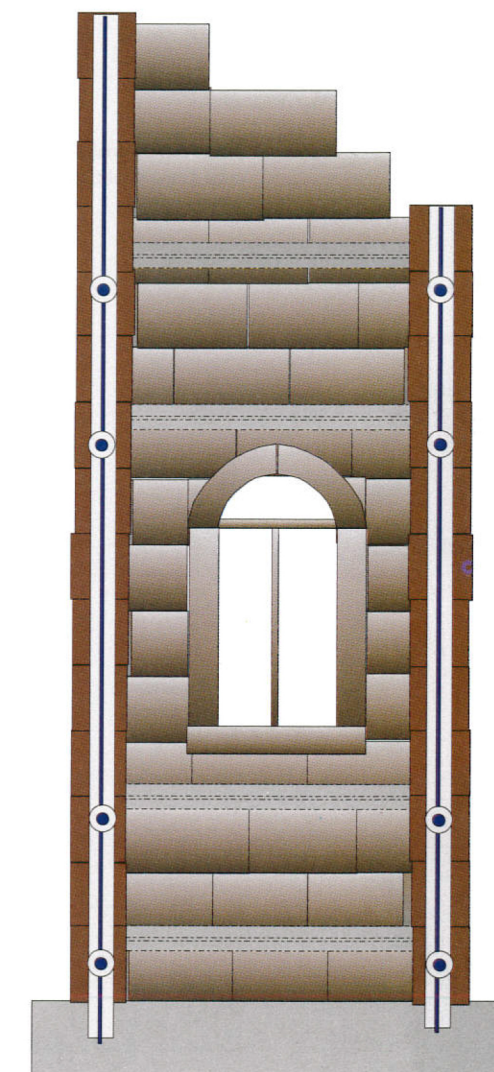

section

Canada

Cintec Reinforcement Systems
38 Auriga Drive, Suite 200
Nepean, Ontario, Canada
K2E 8A5
Tel: (1) 613 225-3381
Fax: (1) 613 224-9042
E-mail: solutions@cintec.com

United States

Cintec America Inc.
200 International Circle, Suite 5100,
Hunt Valley, Maryland
21030, USA
Tel: 1 410 761-0765
1 800 363-6066
Fax: 1 800 461-1862
E-mail: solutions@cintec.com

United Kingdom

Cintec International Ltd.
Cintec House
11 Gold Tops
South Wales, UK
Newport NP204PH
Tel: +44 (0) 1633 246614
Fax: +44 (0) 1633 246110
E-mail: hqcintec@cintec.co.uk

CINTEC
NORTH AMERICA
SECURING THE PAST FOR THE FUTURE

CINTEC
NORTH AMERICA
SECURING THE PAST FOR THE FUTURE

Method of providing an internal spine of steel into the core of a weak structure. The connection of anchors within structures.

Interlocking sock method

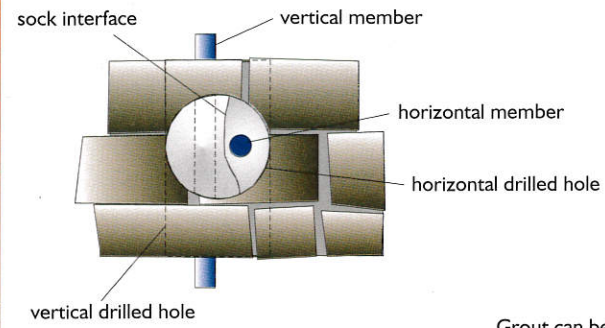

Dimensions dependent on loads required and parent material strengths

Intersecting rings, squares or rectangles attached to main body with either welded or screw fixings

anchor body to be solid, SHS or CHS. mild, stainless or high tensile steel

Anchor sizes, drilled hole sizes dependent on structure and layout

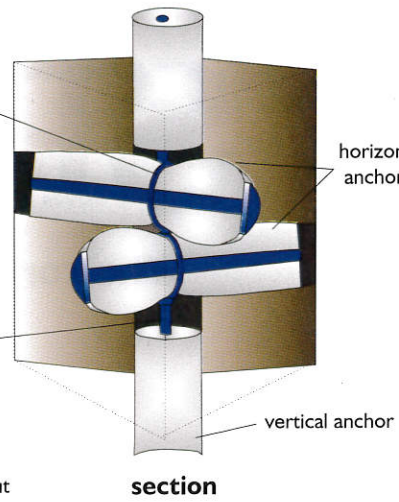

Interlocking sock joint

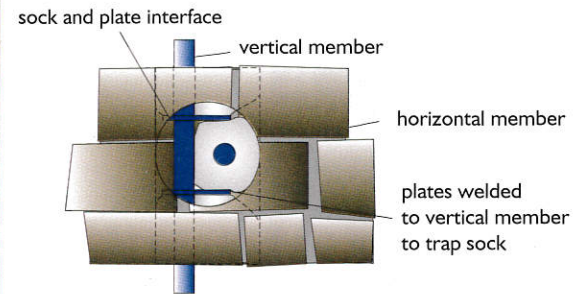

Grout can be designed to be sympathetic to parent material

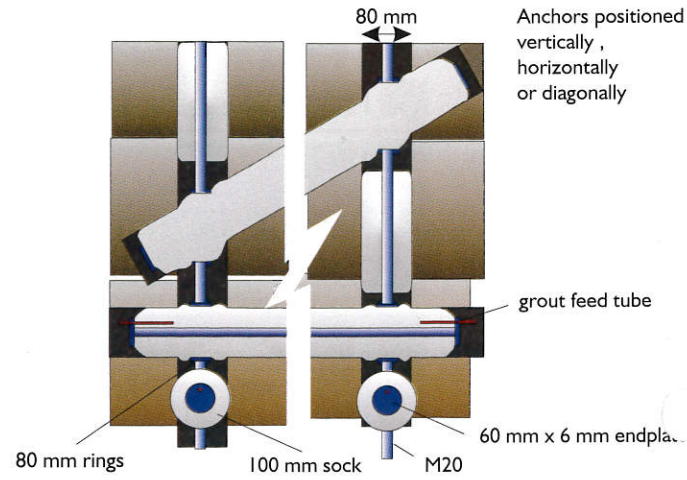

Installation technique

Phase 1 detailed survey of structure including detailed horizontal and vertical dimensions.

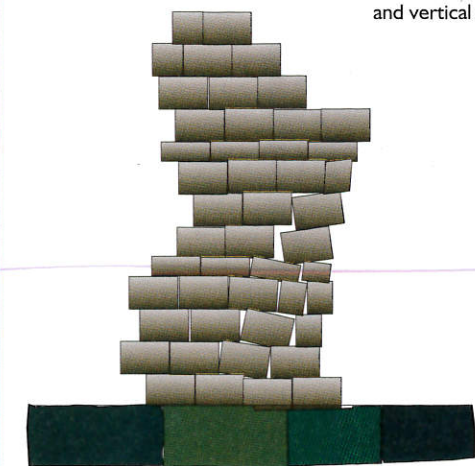

ELEVATION

Phase 2 Erect purpose designed metal jig to surround structure with known dimensions

Purposed built scaffold jig erected around structure

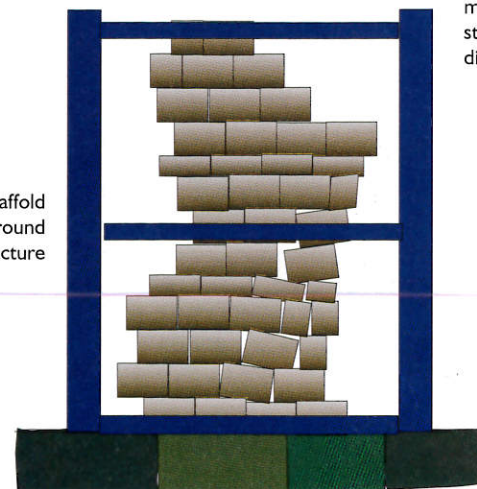

PLAN

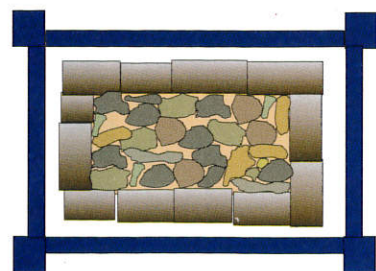

Spinetec

Phase 3 Line scaffold with plywood to totally enclose structure. Fill polythene bags with lightweight grout and position them between plywood and masonry from the bottom up.

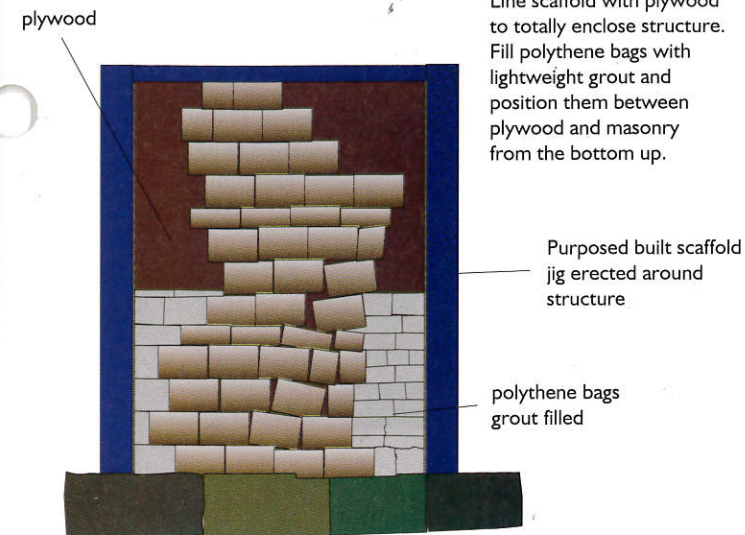

elevation

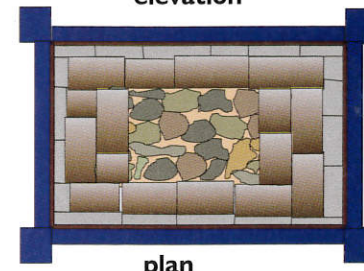

plan

Purposed built scaffold jig erected around structure

polythene bags grout filled

Phase 4 Carefully set location of vertical and horizontal anchor positions. Diamond drill hole from the supporting jig.

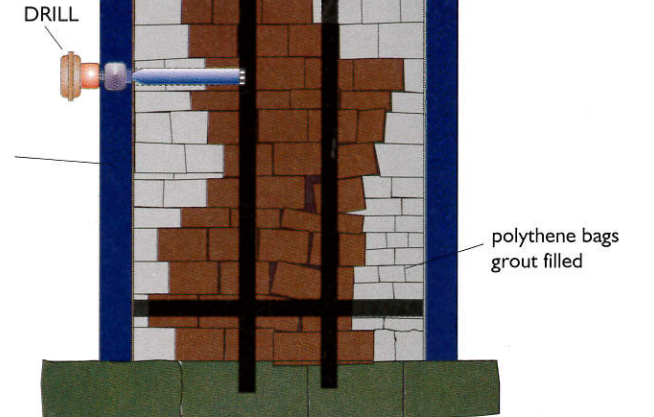

section

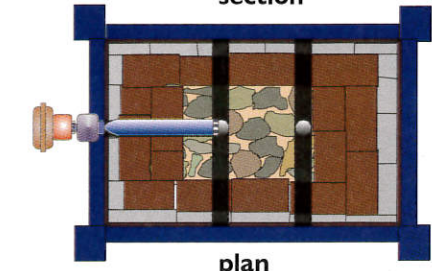

plan

Phase 5 Carefully set anchors in predetermined holes

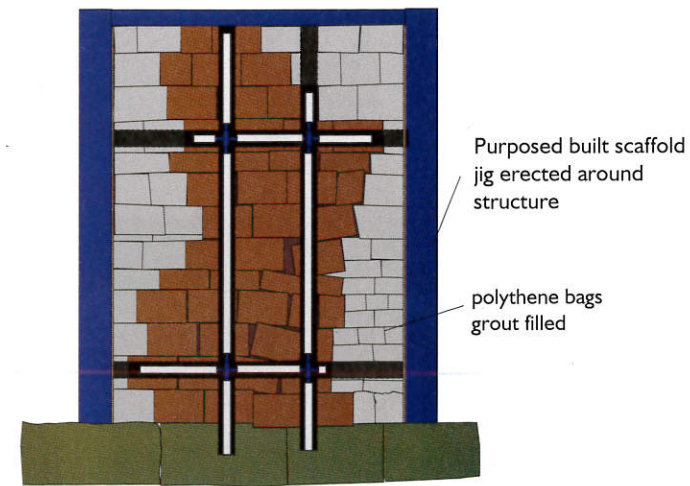

section

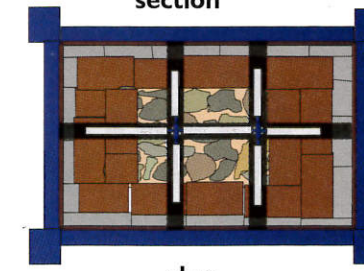

plan

Purposed built scaffold jig erected around structure

polythene bags grout filled

Phase 6 anchors are inflated and the masonry cores reinstated



section

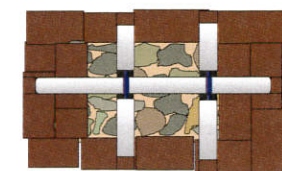

plan

Scaffold and temporary supports removed without damaging structure.

Spinetec